

WESEAL

**Catalogue
2012**



CONTENTS

	PAGE
COMPANY INTRODUCTION	1
CATALOGUE INTRODUCTION	1
WESEAL COMPONENT MATERIALS	2
WATER PUMP APPLICATION	
TYPE F010	3
TYPE F040	4
TYPE F050	5
TYPE DEF0	6
TYPE F020 , TYPE F030	7
TYPE FBA0	8
TYPE F5020	9
TYPE F170	10
TYPE HLA0	11
CHEMICAL PUMP APPLICATION	
TYPE HM70 , TYPE H8A0	12
CHEMICAL MECHANICAL SEALS	
TYPE H970	13
TYPE H9G0 , TYPE H9G0	14
TYPE FC48D0	15
CARTRIDGE SEALS	
TYPE FEM40	16
FOOD GRADE MECHANICAL SEALS	
FOOD GRADE MECHANICAL SEALS	17
OTHER SPARE PARTS OF PUMP	
SPARE PARTS OF MECHANICAL SEALS	18-19
MEMO	20

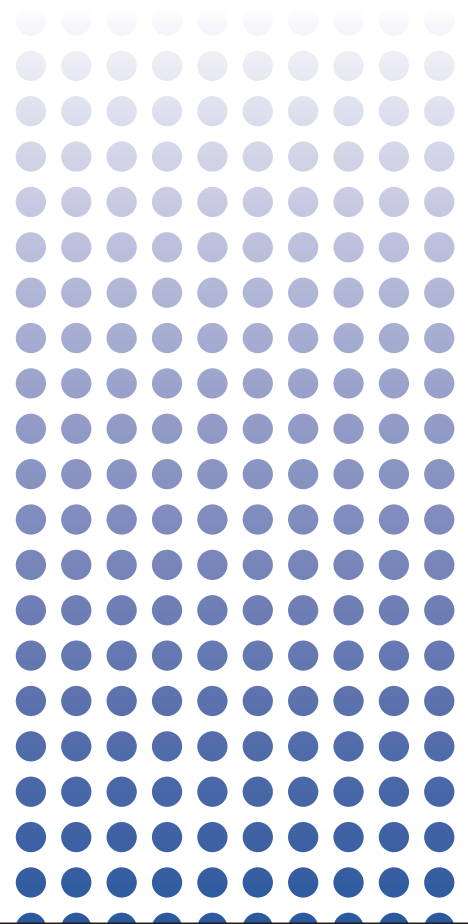

WESTSIDE LTD.

ADDRESS→ 2FL., No.3, Alley4, Lane185, Sec.6,
Chung Shiao E. Rd., Taipei, Taiwan, R.O.C.
TEL→ +886 (2) 2785 9030
FAX→ +886 (2) 2785 7602
EMAIL→ weseal@ms22.hinet.net
WEBSITE→ <http://www.westside.com.tw>

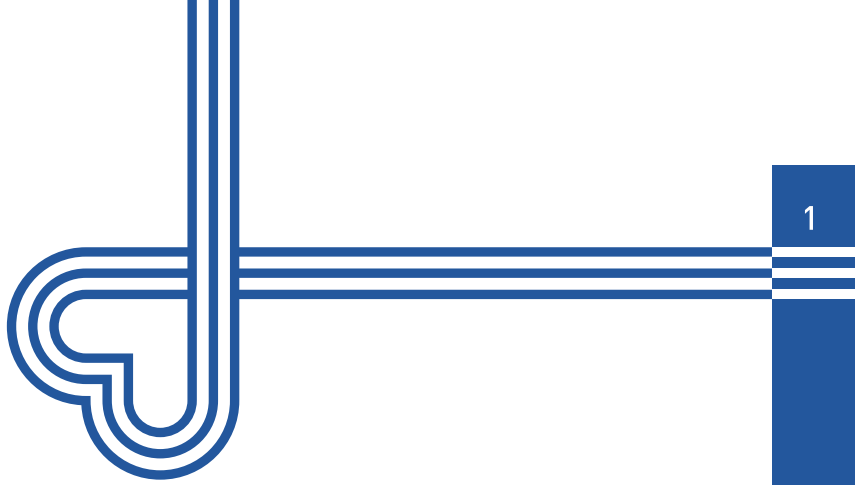

CATALOGUE INTRODUCTION

This catalogue is a subset of the whole mechanical seals selection offered by Westside Ltd. Items have been listed by application type: starting from commercial water pumps all the way through heavy duty cartridge seals. In each page, we include photos, drawings, dimensions and potential application. We hope this catalogue will help make the selection of seals more efficient for our customers.

More importantly, we understand that there are always special applications. For your custom seal need, please always feel free to contact us with your specifications or samples. Our customer service is here to provide the best seal solution to meets your requirements.

WESEAL



COMPANY INTRODUCTION

Westside Ltd. Has supplied quality-sealing products to the global industrial market place Since 1981. Located in Taiwan, we are committed to reducing pump parts life cycle cost for any pumping jobs. We have facilities in Taiwan and Shanghai for global and Asia market. And, have been operating 2 factories in China since 1991. After 20 years of effort on quality, price, and delivery. Westside Ltd. Is proud to boasts the satisfaction of our clients.

Striving for excellence in production, we have developed full range of mechanical seals for a variety of different industrial applications.

Based on our production experience and innovative spirit, we have also successfully developed several different kinds of parts for our customers. We are able to provide molded and machined parts with numerous materials, such as Teflon, Viton, silicon rubber, stainless steel, Silicon carbide...etc.

Fully customized applications are always welcome.

Should you have any questions, please don't hesitate to contact with us. We look forward to hearing from you soon!

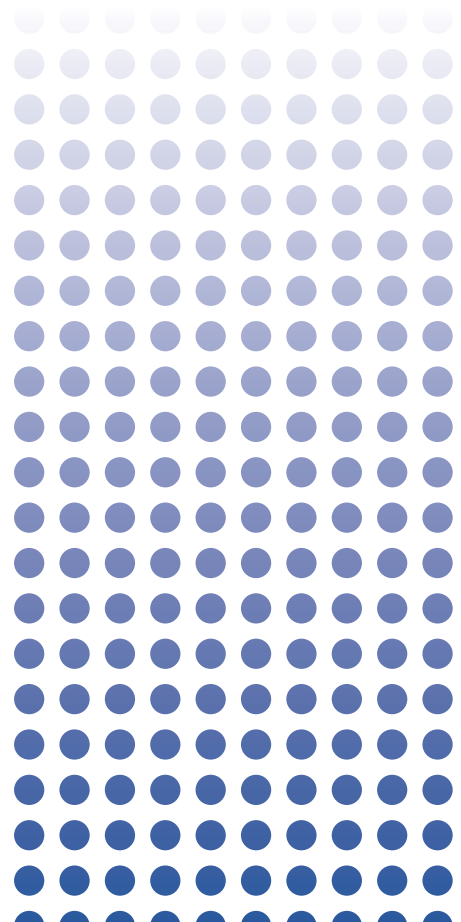

WESEAL MATERIALS INTRODUCTION

A		B		C	
RUBBER PARTS		ROTARY & STATIONARY FACES		METAL PARTS	
MATERIAL	CODE	MATERIAL	CODE	MATERIAL	CODE
1.NBR	B	1.CARBON	C	1.SUS304	K
2.HNBR	Y	2.RESIN CARBON GRAPHITE	R	2.SUS316	K6
3.EPDM	H	3.ANTIMONY CARBON GRAPHITE	Q	3.HASTELLOY	K7
4.FKM	V	4.SILICON CARBIDE	Z		
5.FFKM	V1	5.CERAMIC	J		
6.PTFE	F	6.TUNGSTEN CARBIDE	T		
		7.SUS304	K		

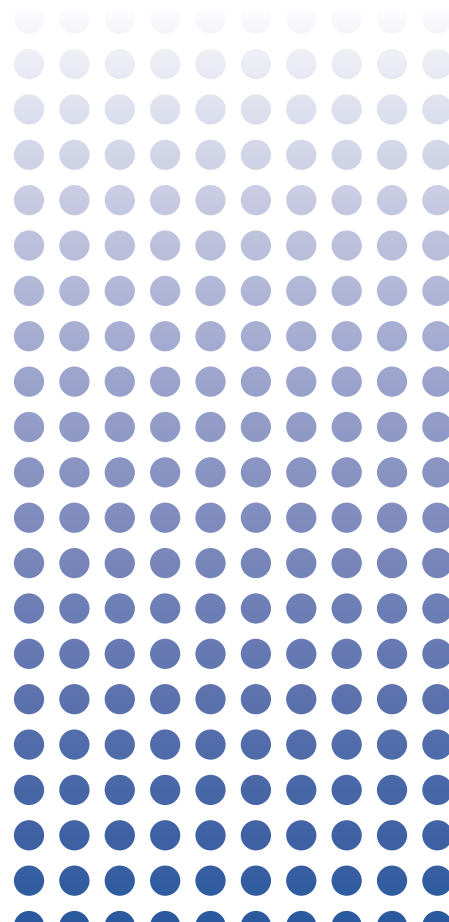
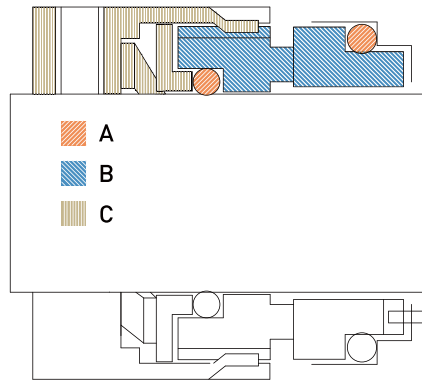

F010

PERFORMANCE CAPABILITIES

Temperature: → 4°F to 355°F
(Depending on material composition.)

Pressure: → Up to 145 psig

Shaft Speed: → Up to 10 m/s

APPLICABLE INDUSTRIES

Automobile Industry, Food & Drink Processing,
Petrochemical, Paper-Making Industry,
Wastewater Treatment & Water Relevant Industry.

APPLICABLE MACHINE

Centrifugal Pumps, Water Pumps,
Rotary Pumps and other machines with rotary axis.

European and Japan standard stationary seats are also available.

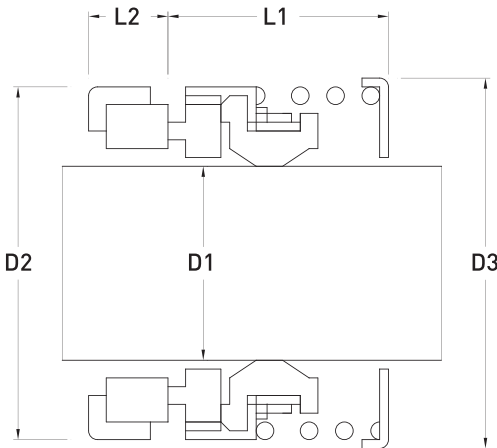

DIMENSION TABLE INCH SIZE

ITEM NO	D1		D2	D3	L1	L2
	SHAFT		SEAT BORE	HEAD O.D.	HEAD HEIGHT	SEAT HEIGHT
	INCH	MM	MM	MM	MM	MM
F0100500	0.500"	12.700	25.40	23.80	20.50	7.92
F0100625	0.625"	15.875	31.75	26.97	22.20	10.28
F0100750	0.750"	19.050	34.92	30.15	22.20	10.28
F0100875	0.875"	22.225	38.10	33.32	23.60	10.28
F0101000	1.000"	25.400	41.27	42.85	24.90	11.10
F0101125	1.125"	28.575	44.45	46.02	26.80	11.10
F0101250	1.250"	31.750	47.62	49.20	26.80	11.10
F0101375	1.375"	34.925	50.80	52.37	26.80	11.10
F0101500	1.500"	38.100	53.97	55.55	28.40	11.10
F0101625	1.625"	41.275	60.32	63.50	34.80	12.70
F0101750	1.750"	44.450	63.50	66.67	34.80	12.70
F0101875	1.875"	47.625	66.67	69.85	37.60	12.70
F0102000	2.000"	50.800	69.85	73.02	37.60	12.70
F0102125	2.125"	53.900	76.20	73.30	41.88	14.28
F0102250	2.250"	57.100	79.38	78.40	41.88	14.28
F0102375	2.375"	60.300	82.55	82.00	46.02	14.28
F0102500	2.500"	63.500	85.73	84.90	46.02	14.28
F0102625	2.625"	66.600	85.73	88.40	49.20	15.90
F0102750	2.750"	69.800	88.90	92.60	49.20	15.90
F0102875	2.875"	73.000	95.25	94.85	52.33	15.90
F0103000	3.000"	76.200	98.43	101.50	52.33	15.90
F0103250	3.250"	82.550	104.78	108.00	55.50	19.80
F0103375	3.375"	85.730	119.06	114.30	55.50	19.80

DIMENSION TABLE MM SIZE

ITEM NO	D1	D2	D3	L1	L2
	SHAFT	SEAT BORE	HEAD O. D.	HEAD HEIGHT	SEAT HEIGHT
	MM	MM	MM	MM	MM
F01010MM	10	24	22.00	16.50	6.50
F01011MM	11	24	23.80	16.50	6.50
F01012MM	12	26	23.80	20.68	6.50
F01014MM	14	28	27.00	18.30	6.50
F01015MM	15	28	27.00	18.30	6.50
F01016MM	16	32	27.00	19.80	7.00
F01018MM	18	35	30.15	18.32	10.28
F01019MM	19	35	30.15	18.32	10.28
F01020MM	20	38	33.50	19.80	8.00
F01022MM	22	40	33.50	19.30	8.50
F01025MM	25	44	43.00	20.30	8.50
F01028MM	28	46	46.00	21.30	8.50
F01030MM	30	50	49.10	21.80	9.00
F01032MM	32	54	49.10	23.80	9.00
F01035MM	35	58	52.30	25.30	10.50
F01038MM	38	60	55.50	26.30	10.50
F01040MM	40	64	63.50	26.80	11.00
F01045MM	45	66	66.60	28.80	11.00
F01050MM	50	72	73.00	30.89	11.00

F040

DIMENSION TABLE INCH SIZE

PERFORMANCE CAPABILITIES

Temperature: → -4°F to 355°F

(Depending on material composition.)

Pressure: → Up to 170 psig

Shaft Speed: → Up to 10 m/s

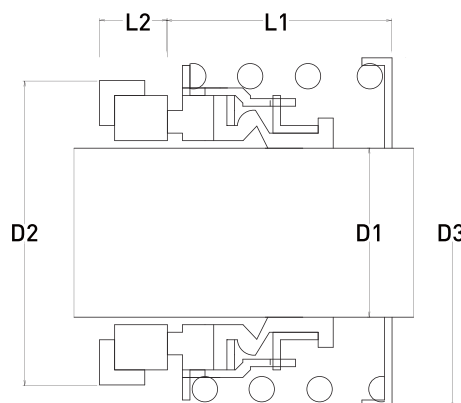

APPLICABLE INDUSTRIES

Food & Drink Processing, Petrochemical, Paper-Making Industry, Pharmaceutical, Wastewater Treatment & Water Relevant Industry, Power Generation.

APPLICABLE MACHINE

Pump, Freezing Compressor and other machine with rotary axis.

ITEM NO	D1		D2	D3	L1	L2
	SHAFT		SEAT BORE	HEAD O.D.	HEAD HEIGHT	SEAT HEIGHT
	INCH	MM	MM	MM	MM	MM
F0400625	0.625"	15.875	31.75	26.97	22.22	10.2
F0400750	0.750"	19.050	34.92	30.15	22.22	10.2
F0400875	0.875"	22.225	38.10	33.32	23.72	10.2
F0401000	1.000"	25.400	41.27	42.85	24.90	11.1
F0401125	1.125"	28.575	44.45	46.02	26.90	11.1
F0401250	1.250"	31.750	47.62	49.20	26.90	11.1
F0401375	1.375"	34.925	50.80	52.37	28.40	11.1
F0401500	1.500"	38.100	53.97	55.55	28.40	11.1
F0401625	1.625"	41.275	60.32	63.50	34.80	12.6
F0401750	1.750"	44.450	63.50	66.67	34.80	12.6
F0401875	1.875"	47.625	66.67	69.85	37.60	12.6
F0402000	2.000"	50.800	69.85	73.02	37.60	12.6
F0402125	2.125"	53.900	76.20	73.30	41.88	14.2
F0402250	2.250"	57.100	79.38	78.40	41.88	14.2
F0402375	2.375"	60.300	82.55	82.00	46.02	14.2
F0402500	2.500"	63.500	85.73	84.90	46.02	14.2
F0402625	2.625"	66.600	85.73	88.40	49.20	15.8
F0402750	2.750"	69.800	88.90	92.60	49.20	15.8
F0402875	2.875"	73.000	95.25	94.85	52.33	15.8
F0403000	3.000"	76.200	98.43	101.90	52.33	15.8



F050

DIMENSION TABLE INCH SIZE

PERFORMANCE CAPABILITIES

Temperature: → -4°F to 355°F

(Depending on material composition.)

Pressure: → Up to 170 psig

Shaft Speed: → Up to 10 m/s

APPLICABLE INDUSTRIES

Food & Drink Processing, Petrochemical,
Paper-Making Industry, Pharmaceutical,
Wastewater Treatment & Water Relevant Industry,
Power Generation.

APPLICABLE MACHINE

Pump, Freezing Compressor and other machine
with rotary axis

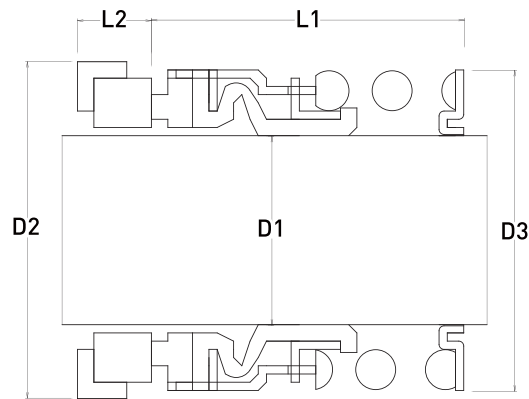

ITEM NO	D1		D2	D3	L1	L2
	SHAFT		SEAT BORE	HEAD O.D.	HEAD HEIGHT	SEAT HEIGHT
	INCH	MM	MM	MM	MM	MM
F0500625	0.625"	15.875	31.75	27.80	33.2	10.2
F0500750	0.750"	19.050	34.92	31.00	33.2	10.2
F0500875	0.875"	22.225	38.10	34.20	35.0	10.2
F0501000	1.000"	25.400	41.27	38.20	39.0	11.1
F0501125	1.125"	28.575	44.45	42.00	41.0	11.1
F0501250	1.250"	31.750	47.62	46.00	41.0	11.1
F0501375	1.375"	34.925	50.80	47.63	42.8	11.1
F0501500	1.500"	38.100	53.97	51.00	42.8	11.1
F0501625	1.625"	41.275	60.32	57.15	50.8	12.6
F0501750	1.750"	44.450	63.50	61.00	50.8	12.6
F0501875	1.875"	47.625	66.67	63.50	53.9	12.6
F0502000	2.000"	50.800	69.85	67.00	53.9	12.6
F0502125	2.125"	53.900	76.20	72.00	60.3	14.2
F0502250	2.250"	57.100	79.38	75.00	60.3	14.2
F0502375	2.375"	60.300	82.55	78.00	63.5	14.2
F0502500	2.500"	63.500	85.73	81.00	63.5	14.2
F0502625	2.625"	66.600	85.73	86.00	69.8	15.8
F0502750	2.750"	69.800	88.90	89.00	69.8	15.8
F0502875	2.875"	73.000	95.25	92.20	73.0	15.8
F0503000	3.000"	76.200	98.43	95.30	71.4	15.8



DEFO

DIMENSION TABLE MM SIZE

PERFORMANCE CAPABILITIES

Temperature: → -4°F to 355°F

(Depending on material used.)

Pressure: → Up to 145 psig

Shaft Speed: → Up to 10 m/s

APPLICABLE INDUSTRIES

Food & Drink Processing, Petrochemical,
Paper-Making Industry, Pharmaceutical,
Wastewater Treatment & Water Relevant Industry,
Power Generation.

APPLICABLE MACHINE

Varies submersible pumps and sewage pumps

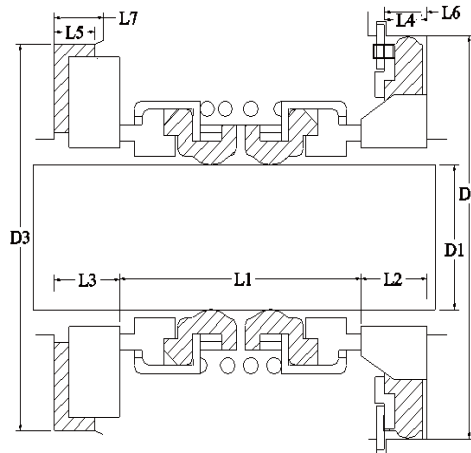

ITEM NO	D1	D2	D3	L1	L2	L3
FULL SET SEALS	SHAFT	BORE	BORE	HEAD HEIGHT	SEAT HEIGHT	SEAT HEIGHT
	MM	MM	MM	MM	MM	MM
DEF020MM	20	44	38	34.5	7	7
DEF025MM	25	50	44	34.5	7	7
DEF030MM	30	57	50	41.5	9	8
DEF035MM	35	64	58	42.5	9	9
DEF040MM	40	70	64	43.5	11	9
DEF045MM	45	70	66	46.5	10	9
DEF050MM	50	80	72	50.5	10	9



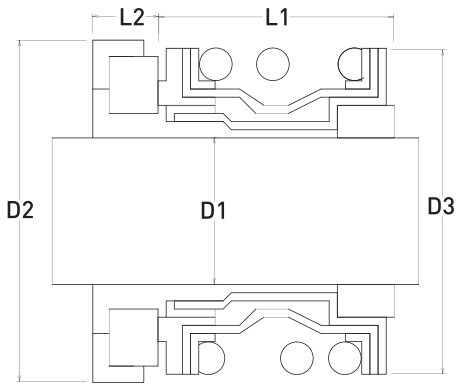

F020

DIMENSION TABLE INCH SIZE

ITEM NO	D1		D2	D3	L1	L2
	SHAFT		SEAT BORE	HEAD O.D.	HEAD HEIGHT	SEAT HEIGHT
	INCH	MM	MM	MM	MM	MM
F0200500	0.500"	12.70	25.40	26.9	15.93	7.93
F0200625	0.625"	15.88	31.75	30.9	18.71	10.29
F0200750	0.750"	19.05	34.93	34.1	18.71	10.29
F0201000	1.000"	25.40	41.28	42.8	20.65	11.10

PERFORMANCE CAPABILITIES

Temperature: → -4°F to 355°F (Depending on material composition.)

Pressure: → Up to 145 psig

Shaft Speed: → Up to 5 m/s

APPLICABLE INDUSTRIES

Pool & Spring, Heating & Refrigeration Systems.

APPLICABLE MACHINE

Small Centrifugal Water Pumps, Pumps for swimming pool, Wastewater Pumps.



F030

DIMENSION TABLE MM & INCH SIZE

TYPE F03A
ALSO AVAILABLE

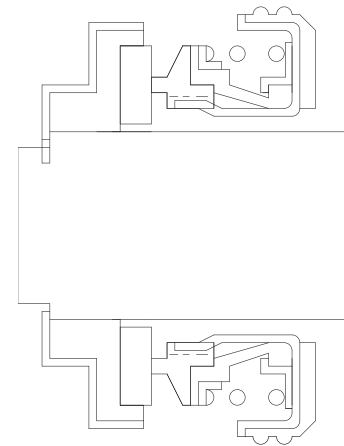
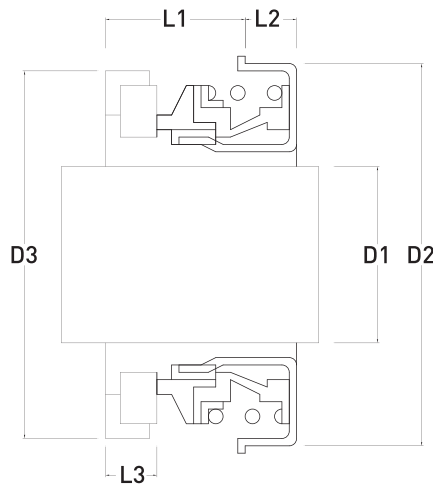

ITEM NO	D1	D2	D3	L1	L2	L3
FULL SET SEALS	SHAFT MAX	HEAD BORE	SEAT BORE	WORKING HEIGHT	DEPTH OF HEAD BORE	SEAT HEIGHT
F0300500	12.7	28.55	25.40	13.13	8.0	7.93
F0300625	17.0	36.45	31.75	17.10	8.0	10.30
F0300750	20.0	40.00	34.93	16.30	9.5	10.30
F03020MM	20.0	40.00	35.00	11.00	9.5	5.00
F03025MM	25.0	47.00	46.00	16.50	12.0	8.50

PERFORMANCE CAPABILITIES

Temperature: → -4°F to 355°F (Depending on material composition.)

Pressure: → Up to 58 psig

S Shaft Speed: → Up to 10 m/s

APPLICABLE MACHINE

Small Centrifugal Water Pumps, Pumps for swimming pool, Wastewater Pumps, High Pressure Pumps, Submersible Pumps.

MAXIMUM SHAFT SIZE: 40mm



FBA0

DIMENSION TABLE MM SIZE

PERFORMANCE CAPABILITIES

Temperature: → -4°F to 355°F
(Depending on material composition.)

Pressure: → Up to 200 psig
Shaft Speed: → Up to 10 m/s

APPLICABLE INDUSTRIES

Food & Drink Processing, Petrochemical,
Paper-Making Industry, Pharmaceutical,
Wastewater Treatment & Water Relevant Industry,
Power Generation.

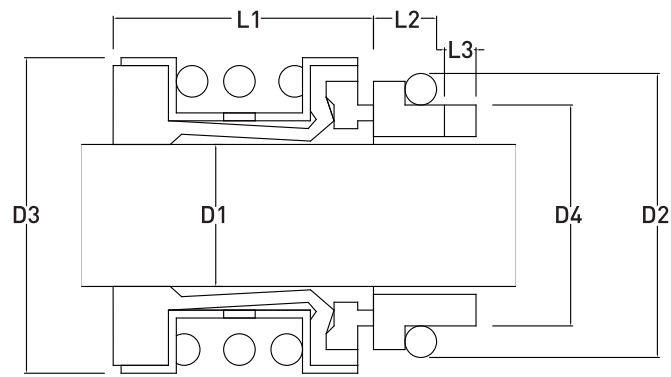

ITEM NO	D1	D2	D3	D4	L1	L2	L3 X W
FULL SET SEALS	SHAFT	SEAT BORE	HEAD O. D.	MINI DIA	HEAD HEIGHT	SEAT HEIGHT	SLOT LENGTH
	MM	MM	MM	MM	MM	MM	MM
FBA020MM	20	35	34	29	20	6.0	0 X 0
FBA025MM	25	40	39	34	20	6.0	0 X 0
FBA030MM	30	45	44	39	26	7.0	0 X 0
FBA032MM	32	48	46	42	26	7.0	0 X 0
FBA035MM	35	50	49	44	26	7.0	0 X 0
FBA038MM	38	56	54	49	30	8.0	0 X 0
FBA040MM	40	58	56	51	30	8.0	0 X 0
FBA043MM	43	61	59	54	30	8.0	0 X 0
FBA045MM	45	63	61	56	30	8.0	0 X 0
FBA050MM	50	70	66	62	30	8.5	5 X 5.5
FBA060MM	60	80	80	72	33	8.5	5 X 5.5
FBA070MM	70	92	90	83	33	8.5	5 X 5.5
FBA075MM	75	97	99	88	40	8.5	5 X 5.5



F5020

DIMENSION TABLE MM SIZE

PERFORMANCE CAPABILITIES

Temperature: → -4°F to 355°F
(Depending on material composition.)

Pressure: → Up to 180 psig
Shaft Speed: → Up to 10 m/s

APPLICABLE INDUSTRIES

Food & Drink Processing, Petrochemical,
Paper-Making Industry, Pharmaceutical,
Wastewater Treatment & Water Relevant Industry,
Power Generation, Desalination System,
Printing & Ink Industry.

APPLICABLE MACHINE

Sea Water Systems, Mixers,
Refrigerating Equipments,
Circulation Systems.

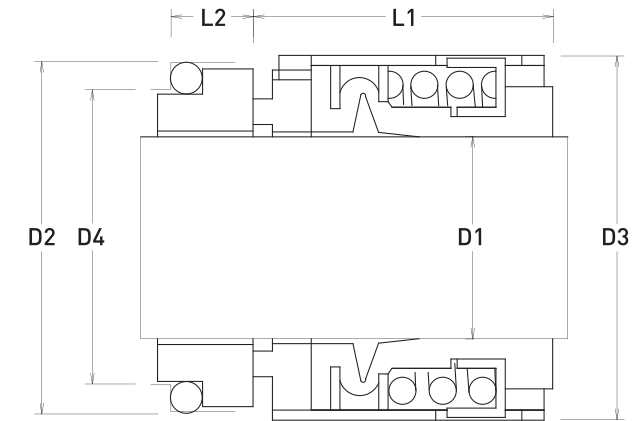

ITEM NO	D1	D2	D3	D4	L1	L2
FULL SET SEALS	SHAFT	SEAT BORE	HEAD O. D.	SEAT BORE	HEAD HEIGHT	SEAT HEIGHT
	MM	MM	MM	MM	MM	MM
F502025MM	25	40	39	34	27.0	12.8
F502028MM	28	43	42	37	30.0	12.3
F502030MM	30	45	44	39	30.5	11.8
F502032MM	32	48	46	42	30.5	11.8
F502033MM	33	48	47	42	30.5	11.8
F502035MM	35	50	49	44	30.5	11.8
F502038MM	38	56	54	49	32.0	12.8
F502040MM	40	58	56	51	32.0	12.8
F502043MM	43	61	59	54	32.0	12.8
F502045MM	45	63	61	56	32.0	12.8
F502048MM	48	66	64	59	32.0	12.8
F502050MM	50	70	66	62	34.0	13.3
F502053MM	53	73	69	65	34.0	13.3
F502055MM	55	75	71	67	34.0	13.3
F502058MM	58	78	78	70	39.0	13.3
F502060MM	60	80	80	72	39.0	13.3



F170

DIMENSION TABLE MM SIZE

PERFORMANCE CAPABILITIES

Temperature: → -4°F to 355°F
(Depending on material composition.)
Pressure: → Up to 145 psig
Shaft Speed: → Up to 10 m/s

APPLICABLE MACHINE

Water pumps,
Heat Treatment and Chemical Pumps,
Water Circulating Pump,
Wastewater Pumps, Sewage Pumps,
Thermal Oil Pumps, Submersible Pumps.

MAXIMUM SHAFT SIZE: 75mm

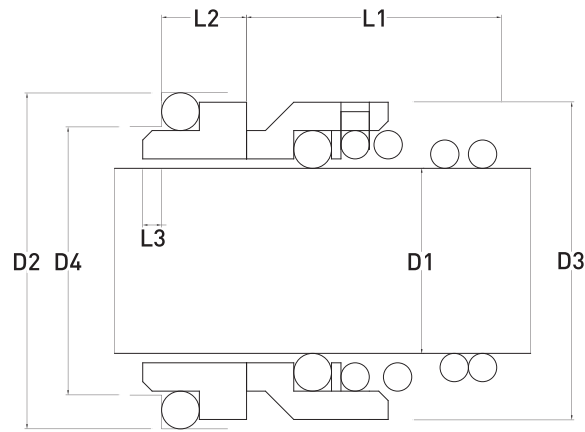

ITEM NO	D1	D2	D3	D4	L1	L2	L3
FULL SET SEALS	SHAFT	SEAT BORE	HEAD O. D.	SEAT BORE	HEAD HEIGHT	SEAT HEIGHT	SEAT HEIGHT
	MM	MM	MM	MM	MM	MM	MM
F17012MM	12	21.6	22	17.5	17.1	5.6	2.6
F17014MM	14	24.6	25	20.5	17.1	5.6	2.6
F17015MM	15	24.6	27	20.5	17.1	6.6	2.6
F17016MM	16	28.0	27	22.0	19.1	7.6	2.6
F17018MM	18	30.0	30	24.0	20.1	8.1	2.6
F17020MM	20	35.0	32	29.5	22.1	7.6	2.6
F17022MM	22	35.0	35	29.5	23.1	7.6	2.6
F17024MM	24	38.0	38	32.0	25.1	7.6	2.6
F17025MM	25	38.0	40	32.0	26.1	7.6	2.6
F17026MM	26	40.0	41	34.0	26.1	8.1	2.6
F17028MM	28	42.0	43	36.0	27.1	9.1	2.6
F17030MM	30	45.0	47	39.2	25.1	10.6	2.6



HLA0

DIMENSION TABLE MM SIZE

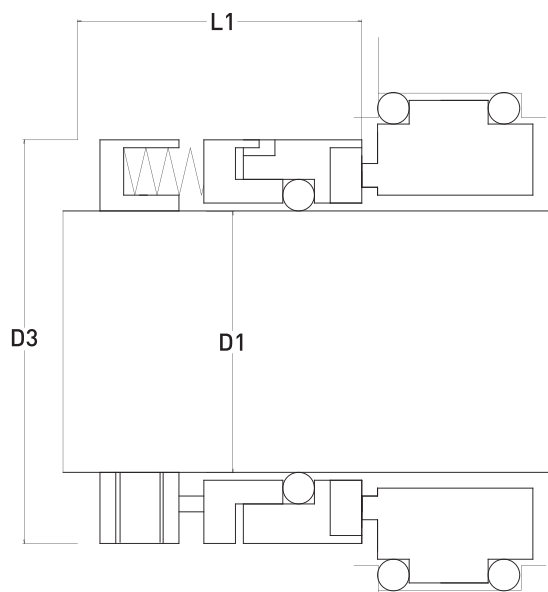

ITEM NO	D1	D3	L1
	SHAFT	HEAD O. D.	HEAD HEIGHT
	MM	MM	MM
HLA020MM	20	34	35
HLA022MM	22	36	35
HLA024MM	24	38	35
HLA025MM	25	39	35
HLA028MM	28	42	35
HLA030MM	30	44	35
HLA032MM	32	46	35
HLA033MM	33	47	35
HLA035MM	35	49	35
HLA038MM	38	54	38
HLA040MM	40	56	38
HLA042MM	42	58	38
HLA043MM	43	59	38
HLA045MM	45	61	38
HLA048MM	48	64	38
HLA050MM	50	66	39
HLA052MM	52	68	40
HLA053MM	53	69	40
HLA055MM	55	71	40
HLA058MM	58	76	41
HLA060MM	60	78	41
HLA062MM	62	80	41
HLA063MM	63	81	41
HLA065MM	65	83	41
HLA068MM	68	86	41
HLA070MM	70	90	42
HLA075MM	75	95	42
HLA080MM	80	100	42
HLA085MM	85	105	43
HLA090MM	90	110	45

PERFORMANCE CAPABILITIES

Temperature: → -4°F to 355°F (Depending on material composition.)
Pressure: → Up to 175 psig
Shaft Speed: → Up to 25 m/s

APPLICABLE INDUSTRIES

Food & Drink Processing, Petrochemical, Paper-Making Industry,
Marine & Ship Building, Wastewater Treatment & Water Relevant Industry, Incinerator.

MAXIMUM SHAFT SIZE: 200mm

HM70

DIMENSION TABLE MM SIZE

PERFORMANCE CAPABILITIES

Temperature: → -4°F to 355°F (Depending on material composition.)
 Pressure: → Up to 200 psig
 Speed: → Up to 20 m/s

APPLICABLE INDUSTRIES

Food & Drink Processing, Chemical industry, Paper-Making Industry,
 Marine & Ship Building Wastewater Treatment system, Incinerator

MAXIMUM SHAFT SIZE: 120mm

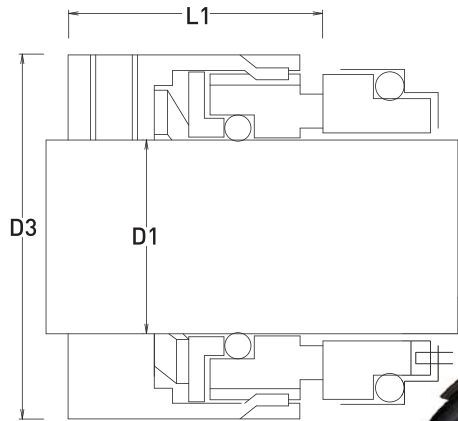

ITEM NO	D1	D3	L1
	SHAFT	HEAD BORE	HEAD HEIGHT
	MM	MM	MM
HM7024MM	24	39.3	28.5
HM7043MM	43	60.3	31.0
HM7045MM	45	62.3	31.0
HM7048MM	48	65.3	31.0
HM7050MM	50	67.3	32.5
HM7053MM	53	70.3	32.5
HM7055MM	55	72.3	32.5
HM7058MM	58	79.3	37.5
HM7060MM	60	81.3	37.5
HM7063MM	63	84.3	37.5
HM7065MM	65	86.3	37.5
HM7068MM	68	89.3	34.5
HM7070MM	70	91.3	42.0
HM7075MM	75	99.3	42.0
HM7080MM	80	104.3	41.8
HM7085MM	85	109.3	41.8
HM7090MM	90	114.3	46.8

H8A0

DIMENSION TABLE MM SIZE

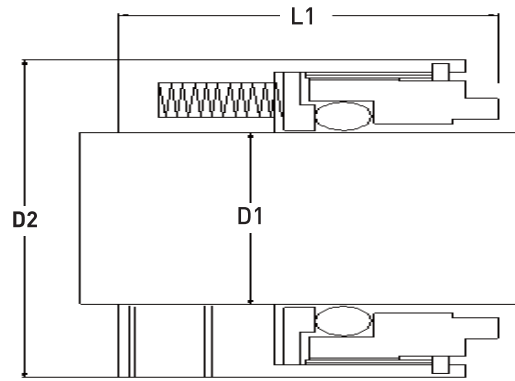

ITEM NO	D1	D2	L1
	SHAFT	HEAD O. D.	HEAD HEIGHT
	MM	MM	MM
H8A020MM	20	34	24.0
H8A025MM	25	39	27.0
H8A030MM	30	44	30.5
H8A035MM	35	49	30.5
H8A038MM	38	54	32.0
H8A040MM	40	56	32.0
H8A045MM	45	61	32.0
H8A050MM	50	66	34.0
H8A055MM	55	71	34.0
H8A060MM	60	80	39.0
H8A065MM	65	85	39.0
H8A070MM	70	90	45.5

PERFORMANCE CAPABILITIES

Temperature: → -4°F to 355°F (Depending on material composition.)
 Pressure: → Up to 200 psig
 Speed: → Up to 25 m/s

APPLICABLE INDUSTRIES

Food & Drink Processing, chemical industry, Paper-Making Industry,
 Marine & Ship Building Wastewater Treatment system, Incinerator

H970

DIMENSION TABLE MM SIZE

PERFORMANCE CAPABILITIES

Temperature: → -4°F to 355°F (Depending on material composition.)
 Pressure: → Up to 200 psig
 Shaft Speed: → Up to 20 m/s

APPLICABLE INDUSTRIES

Food & Drink Processing, Chemical Industry,
 Paper-Making Industry, Marine & Ship Building,
 Wastewater Treatment system, Incinerator.

DOUBLE SEAL DESIGN IS ALSO AVAILABLE

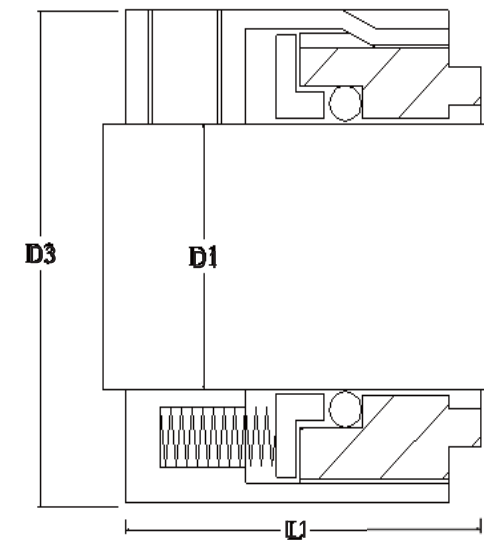

ITEM NO	D1	D3	L1
	SHAFT	HEAD O. D.	HEAD HEIGHT
	MM	MM	MM
H97025MM	25	42	43
H97030MM	30	52	48
H97050MM	50	72	63
H97060MM	60	82	65
H97070MM	70	97	76
H97080MM	80	107	81
H97085MM	85	112	82



H9G0

DIMENSION TABLE MM SIZE

PERFORMANCE CAPABILITIES

Temperature: → -4°F to 355°F (Depending on material composition.)

Pressure: → Up to 350 psig

Shaft Speed: → Up to 18 m/s

APPLICABLE INDUSTRIES

Food & Drink Processing, Chemical Industry, Paper-Making Industry.

APPLICABLE MACHINE

Food processing Machine, Reactor, Stirred Tank.

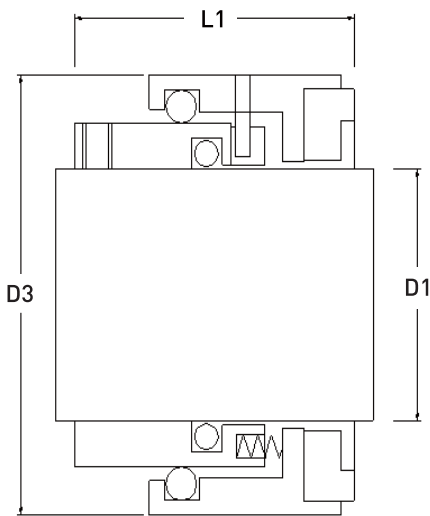

ITEM NO	D1	D3	L1
	SHAFT	HEAD O. D.	HEAD HEIGHT
	MM	MM	MM
H9G030MM	30	44	35.5
H9G035MM	35	49	35.5
H9G043MM	43	59	37.0
H9G045MM	45	61	37.0
H9G050MM	50	66	38.0
H9G053MM	53	69	38.0
H9G055MM	55	71	38.0
H9G060MM	60	80	42.0
H9G065MM	65	85	42.0
H9G070MM	70	90	48.5
H9G075MM	75	99	48.5
H9G080MM	80	104	48.5
H9G090MM	90	114	52.0
H9G095MM	95	119	52.0
H9G0100MM	100	124	52.0



HMB A0

METAL BELLOW

FEATURE

Excellent Corrosion-resistant, applicable for extreme temperature or multiple contaminants environment.

Material: SUS304, SUS316, AM350, Hastolloy.

PERFORMANCE CAPABILITIES

Temperature: → -40°F to 390°F (Depending on material composition.)

Pressure: → Up to 290 psig

Shaft Speed: → Up to 25 m/s

APPLICABLE INDUSTRIES

Petrochemical, Chemical Industry, Paper-Making Industry.

FC48D0

DIMENSION TABLE MM SIZE

ITEM NO	D1	D2	D3	D4	D5	D6	D6	L1	L2	L3	L4	L5
	MM	MM	MM	MM	MM	MM	QTY	MM	MM	MM	MM	MM
FC48D040MM-1	40	38	175	110	145	18	4	159.5	28	8.5	143	44.5
FC48D050MM-1	50	48	240	176	210	18	8	174.5	28	8.5	148	54.5
FC48D060MM-1	60	58	240	176	210	18	8	181.5	28	8.5	158	51.5
FC48D080MM-1	80	78	275	204	240	22	8	217.5	34	8.5	168	83.5
FC48D0100MM-1	100	98	305	234	270	22	8	218.5	34	8.5	178	74.5
FC48D0125MM-1	125	120	330	260	295	22	8	233.5	40	8.5	203	70.5
FC48D0140MM-1	140	135	395	313	350	22	12	250.5	40	8.5	208	82.5
FC48D0160MM-1	160	150	395	313	350	22	12	253.0	40	8.5	213	80.0
FC48D0180MM-1	180	170	445	364	400	22	12	263.5	45	8.5	233	75.5
FC48D0200MM-1	200	190	445	364	400	22	12	271.0	45	8.5	240	76.0

PERFORMANCE CAPABILITIES

Temperature: → -4°F to 480°F

(Depending on material composition.)

Pressure: → Up to 232 psig

Shaft Speed: → Up to 2 m/s

APPLICABLE INDUSTRIES

Chemical Industry.

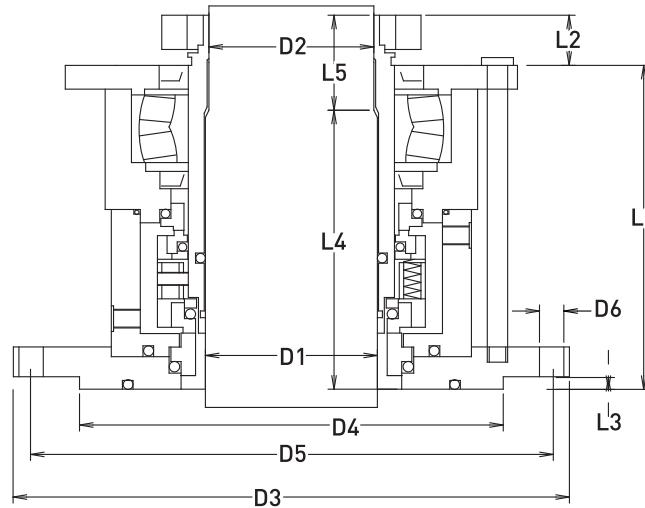

FEM40

DIMENSION TABLE MM SIZE

PERFORMANCE CAPABILITIES

Temperature: → -4°F to 355°F (Depending on material composition.)

Pressure: → Up to 400 psig

Shaft Speed: → Up to 18 m/s

APPLICABLE INDUSTRIES

Food & Drink Processing, Chemical Industry, Paper-Making Industry.

APPLICABLE MACHINE

Food Processing Machine, Reactor, Stirred Tank.



ITEM NO	D1	D2	D3	D6	D7	L	L5	L6	L7	
	MM	MM	MM	MM	MM	MM	MM	MM	MM	QTY
FEM4030MM	30	148	70	0.375	120	97	5	35	13.8	4
FEM4040MM	40	158	80	0.375	130	97	5	35	13.8	4
FEM4050MM	50	168	90	0.375	140	97	5	35	13.8	4
FEM4060MM	60	178	100	0.375	150	97	5	35	18.0	4
FEM4070MM	70	188	110	0.375	160	97	5	35	18.0	4
FEM4080MM	80	198	120	0.375	170	100	5	35	18.0	4
FEM4090MM	90	208	130	0.375	180	100	5	35	18.0	4
FEM40100MM	100	250	150	0.375	210	100	5	35	22.0	4
FEM40110MM	110	260	160	0.375	220	105	5	35	22.0	4
FEM40120MM	120	270	170	0.375	230	105	5	35	22.0	4
FEM40130MM	130	280	180	0.375	240	105	5	35	22.0	4
FEM40140MM	140	290	190	0.375	250	105	5	35	22.0	6
FEM40150MM	150	300	200	0.375	260	105	5	35	22.0	6
FEM40160MM	160	310	210	0.375	270	113	5	35	22.0	6

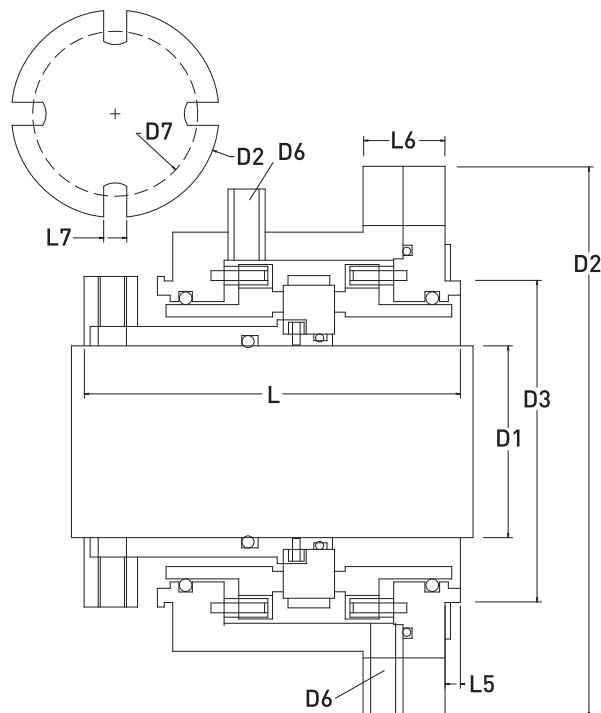

FOOD GRADE MECHANICAL SEALS

APPLICABLE INDUSTRIES

Food & Drink Processing, Pharmaceutical, Biochemical Technical Industry

APPLICABLE MACHINE

Homogenizer, Fermenter, Waste Water Treatment, Sanitary Centrifugal Pumps, Emulsification Mixing tanks.



OTHER SPARE PARTS OF PUMP

Custom made products are always welcome.

CARBON BUSHES

APPLICABLE INDUSTRIES

Food & Drink Processing, Chemical Industry, Textile Industry.

Characteristics:

- *High temperature resistance
- *Anti corrosion
- *Wear-Resistance
- *Good lubrication



ROTARY JOINTS PARTS

APPLICABLE INDUSTRIES

Paper Making Industry- Paper Machine, Dryer.
 Printing and Ink Industry- Roller Dryer, Print Machine.
 Pharmaceutical and Chemical Industry- Grinding Machine.
 Mechanical Industry-Hydraulic Machine, Air Compressor.



PUMP PARTS

SHAFT SLEEVES & THRUST WASHERS

APPLICABLE INDUSTRIES

Food & Drink Processing, Petrochemical, Paper-Making Industry.

Applicable Machines

Self-priming Pumps, Vertical Centrifugal Pumps, Submersible Pumps.



ORING KITS

006	20 pcs	211	10 pcs
007	20 pcs	212	10 pcs
008	20 pcs	213	10 pcs
009	20 pcs	214	10 pcs
010	20 pcs	215	10 pcs
011	20 pcs	216	10 pcs
012	20 pcs	217	10 pcs
110	13 pcs	218	10 pcs
111	13 pcs	219	10 pcs
112	13 pcs	220	10 pcs
113	13 pcs	221	10 pcs
114	13 pcs	222	10 pcs
115	13 pcs	325	7 pcs
116	13 pcs	326	7 pcs
210	10 pcs	327	7 pcs



ORING



Material	Temperature resistant	Feature
NBR (Nitrile Rubber)	-10°F to 210°F	Good resistant to solvent, oil, water and hydraulic fluid. Not recommended for using in highly polar solvents such as acetone, MEK, ozone, chlorinated hydrocarbons and nitro hydrocarbons.
HNBR (Hydrogenate Nitrile)	-10°F to 300°F	Better wear and heat resistance than NBR, excellent resistance to ozone, sunlight, and other atmospheric conditions. Not recommended for exposure to ketone, esters, and aromatic fluids.
EPDM (Ethylene Propylene Rubber)	-55°F to 300°F	Excellent resistance to low temperature, acid and alkali. Not recommended for food applications or exposure to aromatic hydrocarbons.
FKM (Fluoro Carbon Rubber)	-5°F to 480°F	Great resistance to acid and oil, Not recommended for ketones, low molecular weight esters and nitro containing compounds.
FFKM (Perfluoroelastomer Rubber)	-10°F to 620°F	Excellent resistance to heat, acid and plasma. Low outgassing.
PTFE (Polytetrafluoroethylene)	-310°F to 500°F	Excellent Corrosion-resistant and self lubricating. Outstanding application range for temperature use.

WESEAL

WESTSIDE LTD.



ADDRESS → 2FL., No.3, Alley4, Lane185, Sec.6,
Chung Shiao E. Rd., Taipei, Taiwan, R.O.C.

TEL → +886 (2) 2785 9030

FAX → +886 (2) 2785 7602

EMAIL → weseal@ms22.hinet.net

WEBSITE → <http://www.westside.com.tw>

